

ENSIGN DRAIN

Two-piece Ductile Iron Coupling

ED001

DESCRIPTION

The two-piece ductile iron coupling is a mechanical joint coupling. It is used for connecting spigot ended cast iron pipes and fittings and includes an EPDM gasket as standard. Available in diameters 100mm to 300mm. The maximum angular deflection supported between two assembled elements is 3 degrees.

Please note that from 150mm diameter upwards, the couplings have 4 socket bolts to tighten. The 300mm coupling is a four-part assembly.

RECOMMENDED USE

- Domestic use
- Wastewater
- Rainwater
- Runoff water
- Hot effluents

STANDARDS & APPROVALS

- Industry product standard: BS EN 877
- Range fire classification: A2, s1, d0

IDENTIFICATION LABEL

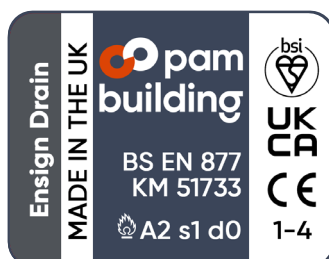

MATERIALS & COATINGS

- Ductile Iron
- Internally and externally coated grey, powder epoxy resin coating, min. average thickness 150 μ m
- EPDM natural rubber gasket to EN 681
- M8 cap set screw and hex head nuts, geomet coated

TECHNICAL FEATURES

- Hot water resistance: 24hr @ 95°C
- Thermal cycle resistance: 1500 cycles between 15°C and 93°C
- Chemical resistance for $1 \leq \text{pH} \leq 13$, up to 80°C
- Salt spray resistance internal coating: more than 3000h
- Salt spray resistance external coating: more than 1500h

ENVIRONMENTAL DATA

- Percentage of recycled content: 99%
- Recycling information: Cast iron is 100% recyclable through the existing recycling industrial network.

Data source: Environmental Product Declaration S-P-02191



ENSIGN DRAIN

Two-piece Ductile Iron Coupling

ED001

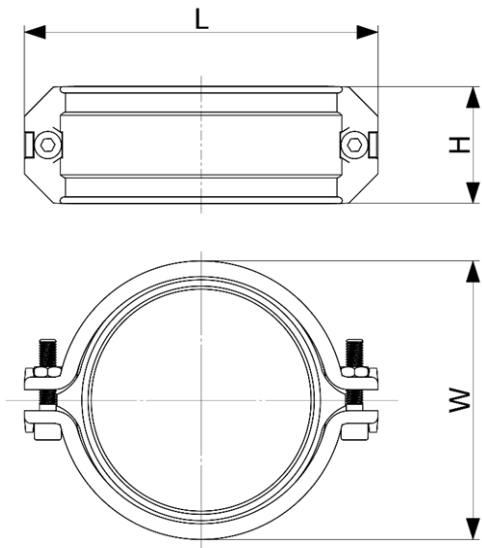

DN	L	W	H	UNRESTRAINED	RESTRAINED	WEIGHT (KG)	PRODUCT CODE
100	170	137	58	Up to 1 bar	Up to 5 bar	1.1	155369
150	217	183	80	Up to 0.5 bar	Up to 5 bar	1.7	155433
200	278	243	82	Up to 0.3 bar	Up to 5 bar	3.7	155462
250	343	307.5	85	Up to 0.3 bar	Up to 3 bar	4.4	175591
300	397.8	398.76	92	Up to 0.3 bar	Up to 3 bar	6.5	175592

- For 400mm, 500mm, 600mm diameters the EC002HP high-performance stainless-steel couplings are required
- Bolts to be tightened to 20Nm if using a torque wrench, the coupling gasket should not protrude
- 6mm allen key required to tighten the coupling bolts
- If using a ratchet spanner – couplings to be tightened to a 2–3mm visible gap at either side of the coupling assembly
- Nitrile gaskets available upon request

Spares kits:

- 100mm gasket (10 pack) – product code 192704
- 150mm gasket (10 pack) – product code 223799
- 250mm gasket (1 pack) – product code 223821
- 200mm & 300mm – please speak to our technical team

This document is provided for information purposes, and our company reserves the right to modify the information contained herein at any time. Our company declines all responsibility of materials that do not comply with the rules prescribed in this document as well with the standards, the technical documents and the applicable professional standards. Any orders placed will be subject to our General Terms and Conditions of Sale, available on request. The drawings and/or images are the exclusive property of Pam Building and are confidential. They must not be reproduced or disclosed to any third party without written consent. They may only be used for the purpose for which they were issued and are returnable on request.