

VORTX ALUMINIUM ROOF OUTLETS

Balcony Spigot Outlet With Flat Grate

VX-AB-F

DESCRIPTION

The aluminium balcony spigot roof outlet ensures a watertight connection between the water/damp proofing membranes and the drainage pipework.

The outlets are designed to allow the unit to be installed against a wall/upstand and the grating can be cut to suit for entry of pipe from above. The spigot is connected to the below pipework with a suitable coupling.

RECOMMENDED USE

- Domestic use
- Rainwater
- Runoff water

STANDARDS & APPROVALS

- Industry product standard: BS EN 1253-2
- Range fire classification: A2,s1,d0

IDENTIFICATION LABEL

- 'pam building' logo located on the top of the flat grate.



TECHNICAL FEATURES

- LM6 aluminium silicon alloy to BS EN 1706:2010
- Grate coated orange, polyester powder coating, average thickness 100µm
- Clamp ring coated grey, polyester powder coating, average thickness 100µm

ENVIRONMENTAL DATA

- Recycling information: Aluminium is 100% recyclable through the existing recycling industrial network.

VORTX ALUMINIUM ROOF OUTLETS

Balcony Spigot Outlet With Flat Grate

VX-AB-F

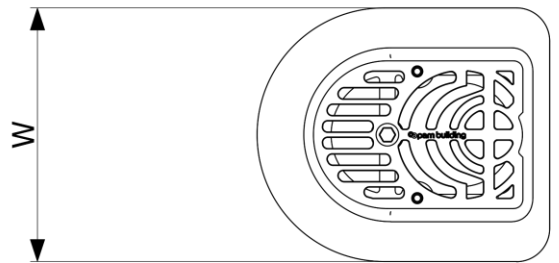
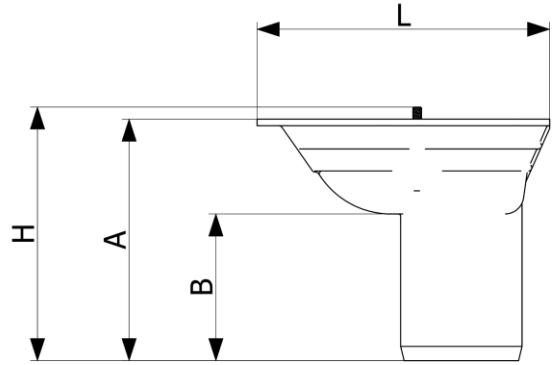

GEN CODE	DN	L	H	W	A	B	FLOWRATE	WEIGHT	PRODUCT CODE
VX-AB2-F	Ø50	265	229	230	218	126	1.7l/s	2.71	286081
VX-AB3-F	Ø75	265	229	230	218	126	5.0l/s	2.74	286080
VX-AB4-F	Ø100	265	229	230	218	133	7.55l/s	2.78	286079

Results are based on a rainfall intensity of 75mm per hour and a 35mm head of water adjacent to the outlet. Flowrate is assuming that the outlet grate is free and clear of any debris/blockages

Accessories available:

- Extension rings
- Threaded adaptors
- Vertical & Two-way outlets are also available

This document is provided for information purposes, and our company reserves the right to modify the information contained herein at any time. Our company declines all responsibility of materials that do not comply with the rules prescribed in this document as well with the standards, the technical documents and the applicable professional standards. Any orders placed will be subject to our General Terms and Conditions of Sale, available on request. The drawings and/or images are the exclusive property of Pam Building and are confidential. They must not be reproduced or disclosed to any third party without written consent. They may only be used for the purpose for which they were issued and are returnable on request.